

Technical data sheet

Junction box T100, plug-in seal, elevated cover

Item number: 2007712



Junction box for the connection of cables and lines indoors and in protected outdoor areas. Rectangular design with plug-in seals to the sides and knock-out entries in the bottom. Suitable for wall and ceiling mounting and on mounting panels. With the option to fasten inside and to mount via the corner domes. High, transparent cover with quick lock, sealable. Made from halogen-free and UV-resistant materials.

With hat profile rail.

Junction box according to DIN EN 60670. Flame-resistant to DIN EN 60695/2/11, test temperature 650 °C. Impact resistance IK07 according to DIN EN 50102. Clear internal dimensions: 136x102x74 mm



PP/
PC

Polypropylene / polycarbonate

Master data

| | |
|------------------------------------|-------------------------------|
| Item number | 2007712 |
| Type | T 100 HD LGR |
| Description 1 | Junction box |
| Description 2 | with raised cover |
| Manufacturer | OBO |
| Dimension | 150x116x83 |
| Colour | Light grey; RAL 7035 |
| Material | Polypropylene / polycarbonate |
| Smallest sales unit | 1 |
| Unit of quantity | Piece |
| Weight | 22.55 kg |
| Weight unit | kg/100 pc. |
| CO2 Footprint (GWP) Cradle-to-Gate | 1,0744 kg CO2e / 1 Piece |

Technical data sheet

Junction box T100, plug-in seal, elevated cover

Item number: 2007712



Dimensions

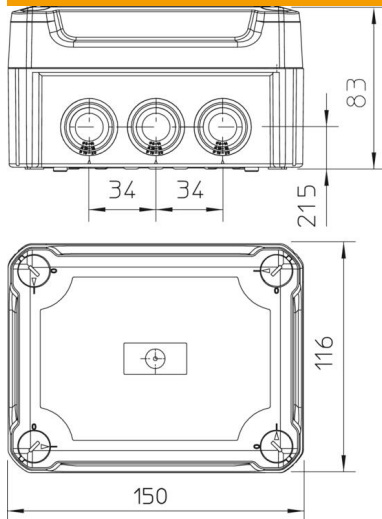

| | |
|--------|--------|
| Length | 150 mm |
| Width | 116 mm |
| Height | 83 mm |

Technical data

| | |
|-----------------------------------|---|
| Expandable | yes |
| No. of entries | 10 |
| Type of entry | Plug-in seal |
| Type of entry | Cable |
| Type of housing penetration | Miscellaneous |
| Measured insulation voltage V_i | 500 V |
| Equipment | Without |
| Cover | Not transparent |
| Cover fastening | Screwed |
| Entry from rear | yes |
| Entries | 10xM25 |
| Explosion-tested version | no |
| Flame-resistant | acc. to VDE 0471/DIN 695 Part 2-1, test temperature 650°C |
| Shape | Rectangular |
| Maintain electrical functions | Without |
| For Ex zone | Without |
| For Ex zone gas | Without |
| For Ex zone dust | Without |
| Halogen-free | yes |
| Clear internal dimensions | 136x102x74 mm |
| With screening | no |
| with lid | yes |
| Mounting type | Wall/ceiling mounting |
| Nominal voltage | 500 V |
| Sealable | yes |
| Protection rating | IP66 |
| Protection rating IK code | IK07. |
| Permitted temperature range, max. | 60 °C |
| Permitted temperature range, min. | -5 °C |

Technical data sheet

Junction box T100, plug-in seal, elevated cover

Item number: 2007712



Technical data

| | |
|-----------------|----|
| Transparent lid | no |
| Weatherproof | no |